

QUESTION No. 1

Two pictorial views and two orthographic views of a desk fan are shown. For drawing purposes, the protective shield is covered and the fan blades are not visible.

- (a) By projecting lines from the front elevation and plan, draw an end elevation of the fan as indicated by the arrow.
- (b) Draw the symbol of projection used.

18 marks

FAN PROTECTIVE SHIELD (COVERED)

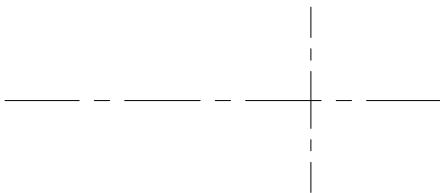
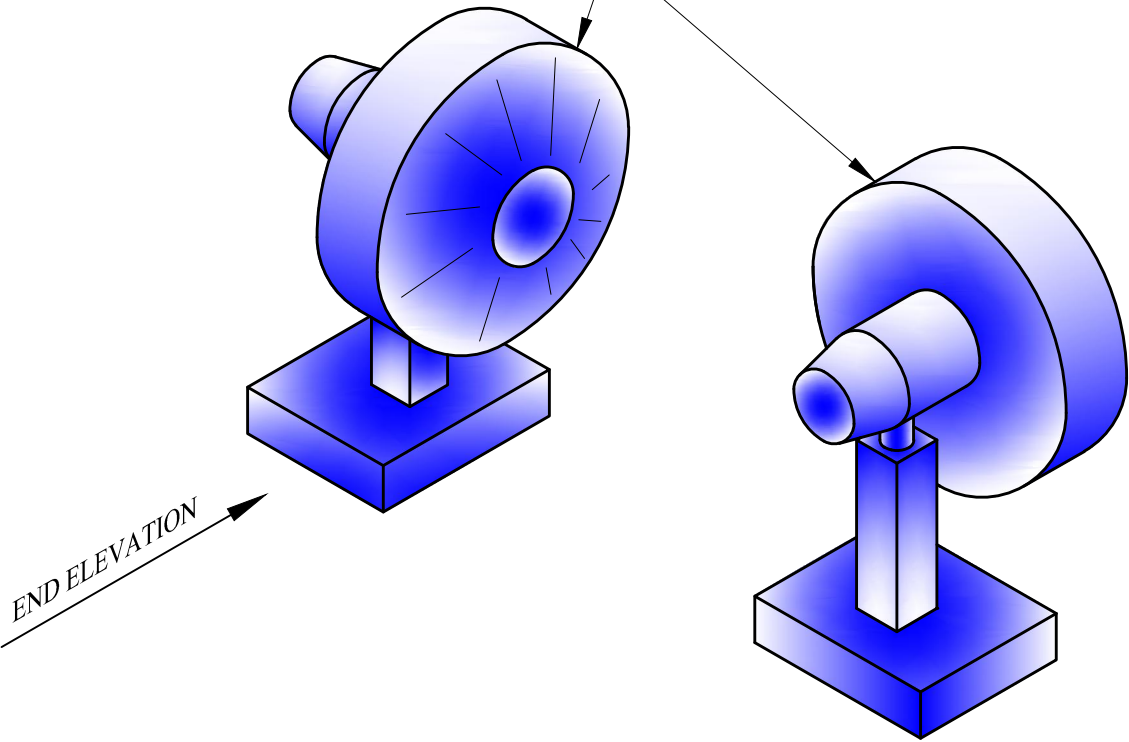

SYMBOL OF PROJECTION

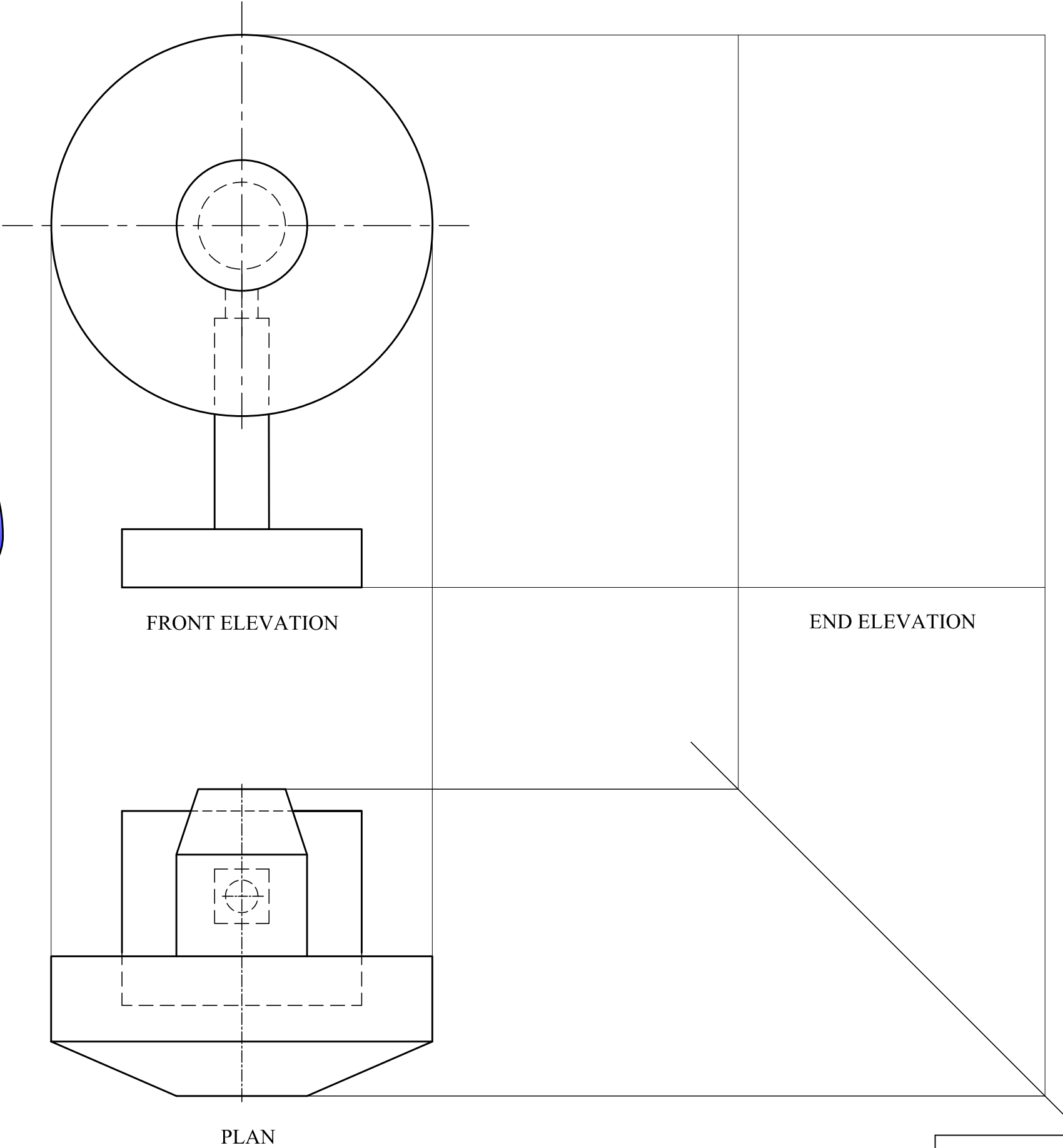

QUESTION No. 2

A round canopy used to collect fumes from a fireplace, is connected to three cylindrical pipes. A front elevation and a plan of pipe X are drawn below. Using the given start lines below, draw the **development** of the pipe assuming the joint to be along AA.

14 marks

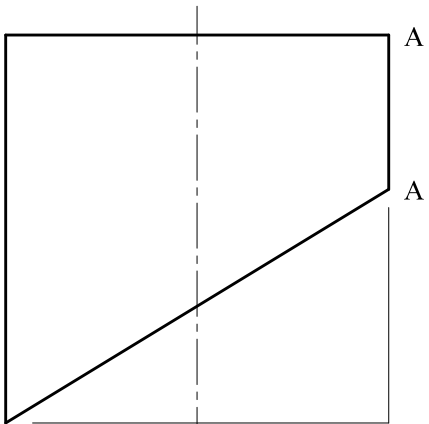

FRONT ELEVATION

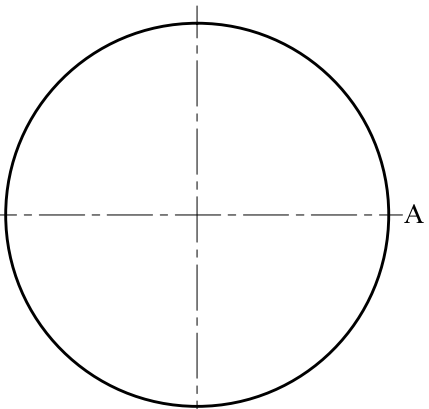

PLAN



DEVELOPMENT

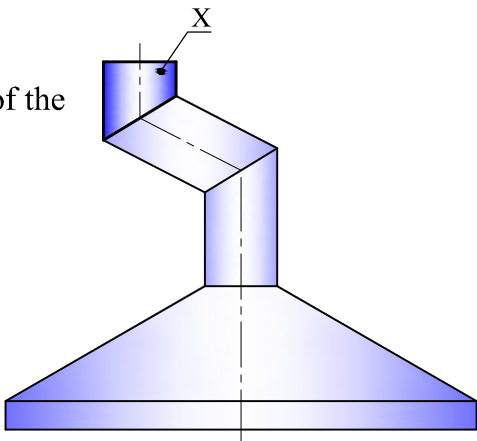

QUESTION No. 3

Two orthographic views of a table with a circular top are shown. Within the given crate, draw an **isometric projection** of the table, putting point X as the lowest corner. Part of the base of the table is already drawn.

16 marks

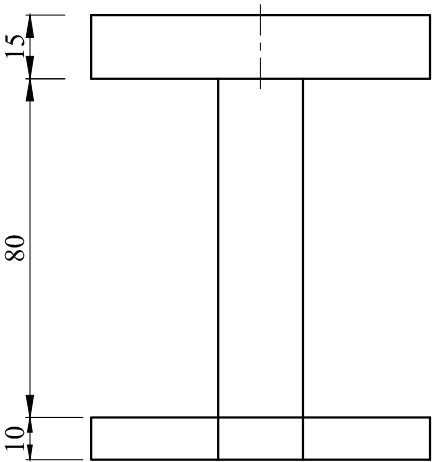
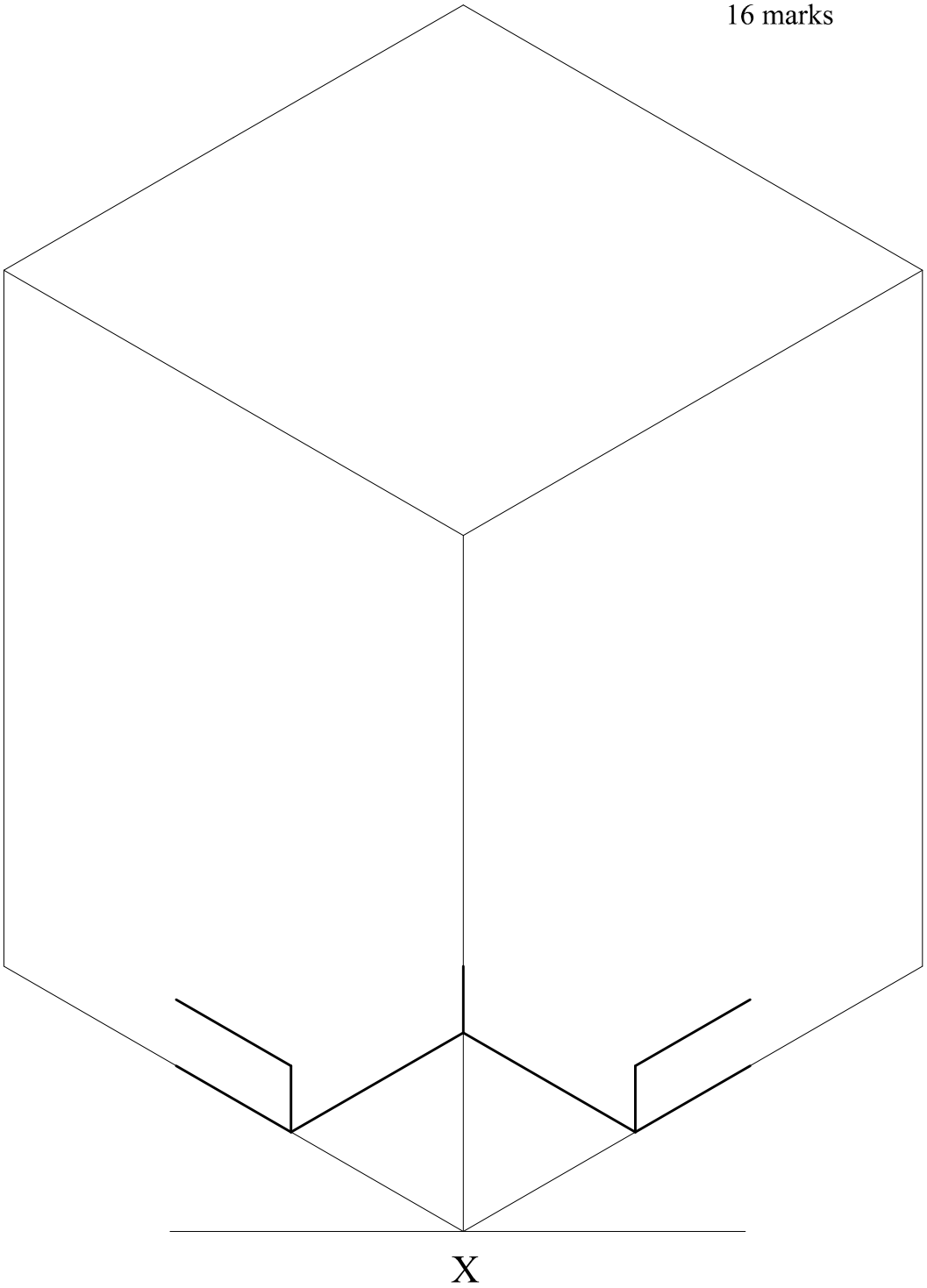

FRONT ELEVATION

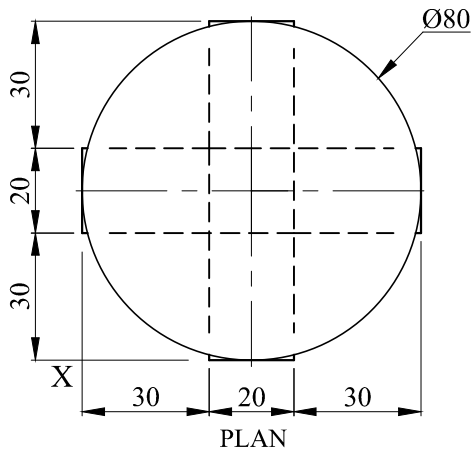

PLAN



QUESTION No. 4

A dimensioned profile of a rabbit and an incomplete version of the head are given. Starting from the given centres A, B, C and D, construct geometrically the remaining part of the rabbit head, showing all construction used to find the centres of the arcs. Also mark the points of tangency. Notes: C is the centre of the arc of radius 72mm. T and P are points of tangency. 14 marks

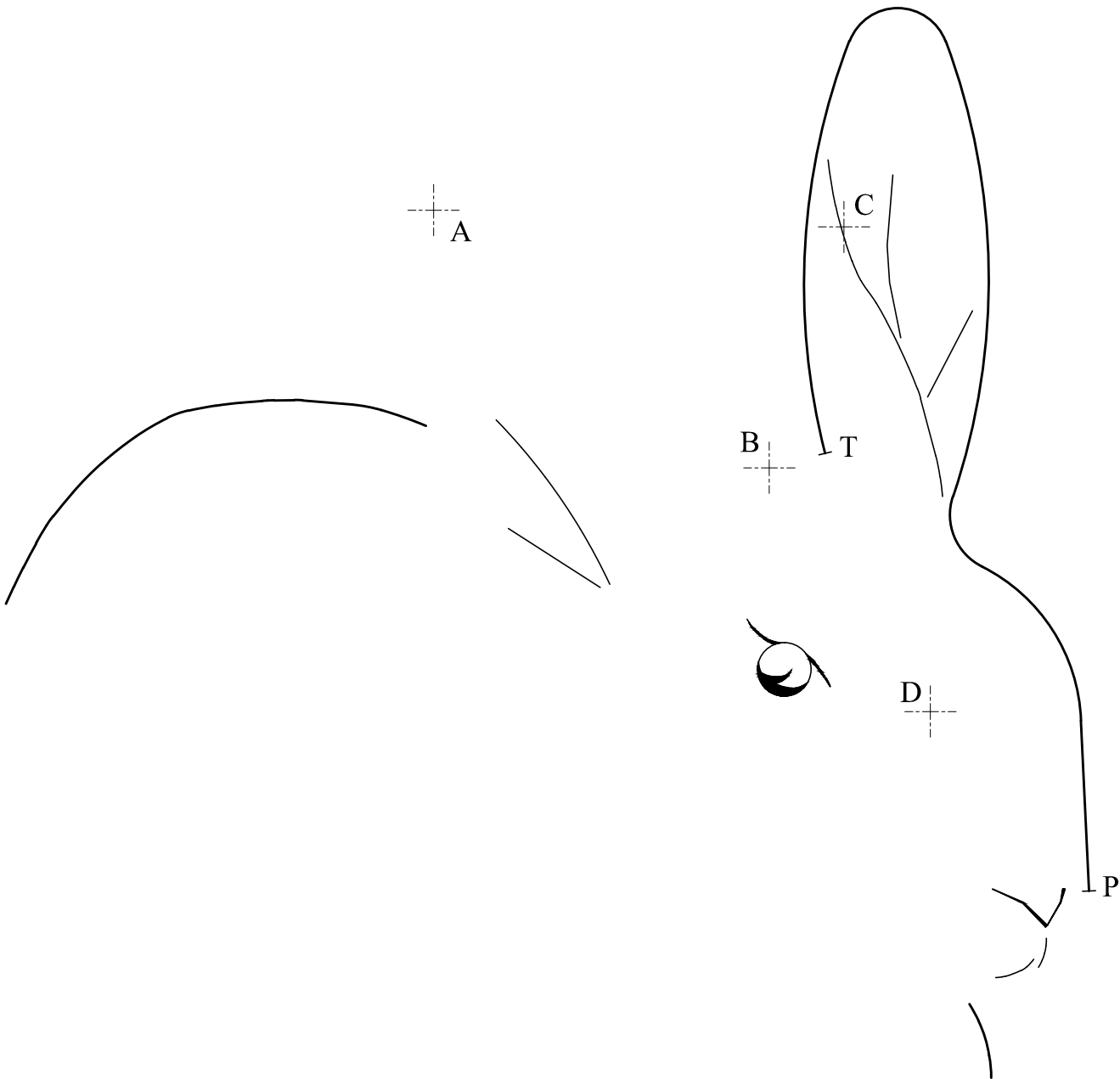
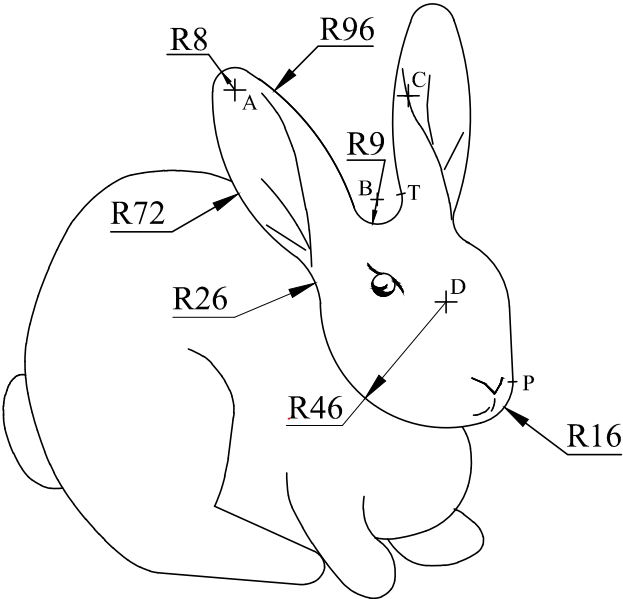

QUESTION No. 5

A lace design is made up of a large number of similar patterns joined together. Enlarge the pattern given below by a ratio of 5:4, taking radial lines from O. Two radial lines are already drawn. 12 marks

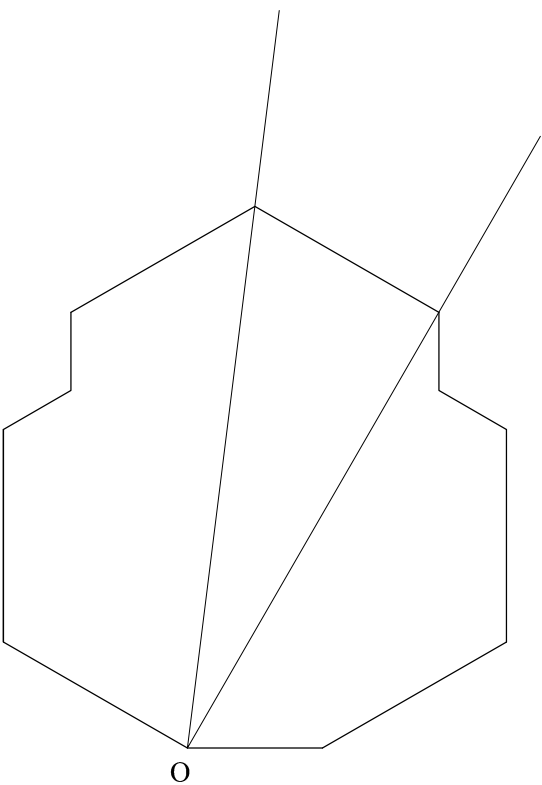
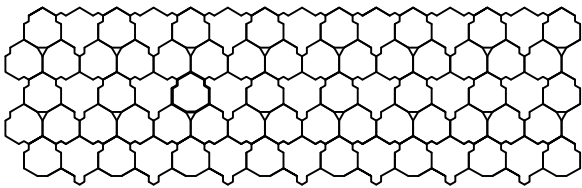

QUESTION No. 6

A number of pulleys are driven by a belt as shown. Two parts of the belt shown below are missing. The part of the belt between pulleys A and B forms a common (external) tangent between two unequal circles. The part between C and D forms a transverse (internal) tangent between two equal circles. Complete the drawing below by constructing the two tangents.

14 marks

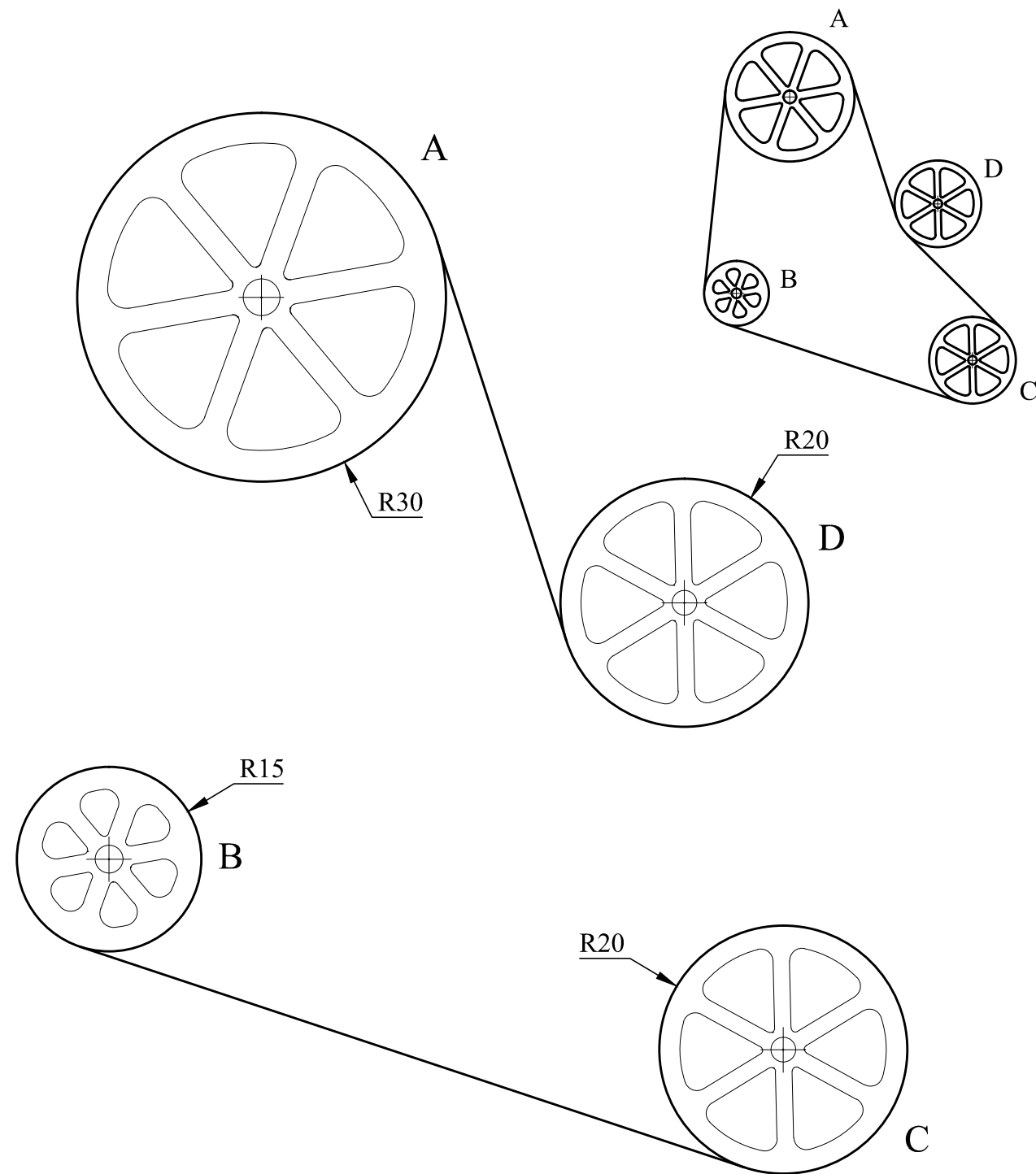

QUESTION No. 7

Using the two circles given at the bottom, draw the eight-pointed star based on the construction shown below. Colour or shade your drawing. All construction lines must be left shown.

12 marks

