

Question 1. An Isometric View and an End Elevation of a DESK ORGANIZER are given. In the space provided and where indicated draw :

- a) the Front Elevation
- b) the Plan
- c) the symbol of the projection used
- d) the scale used.

Notes:

- Material thickness is 10mm throughout
- The three holes have a square base.
- Hidden details **are not** required

30 marks

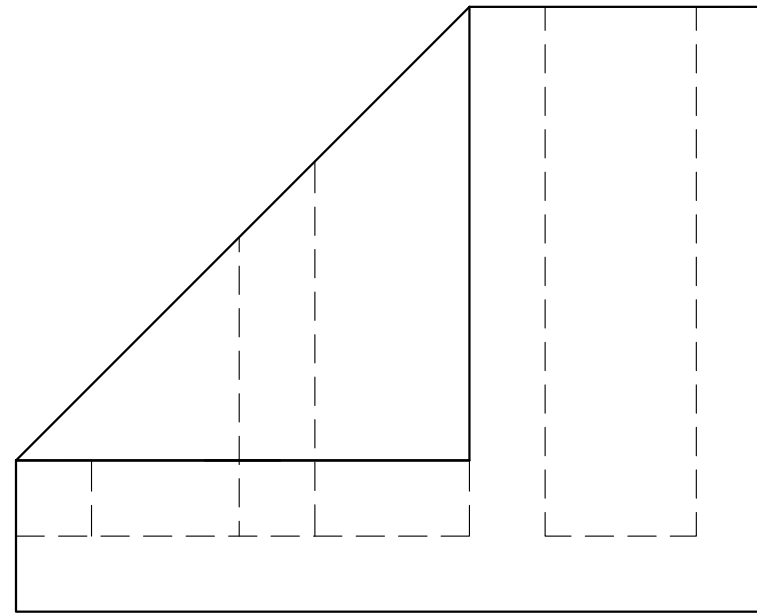

End Elevation

Front Elevation

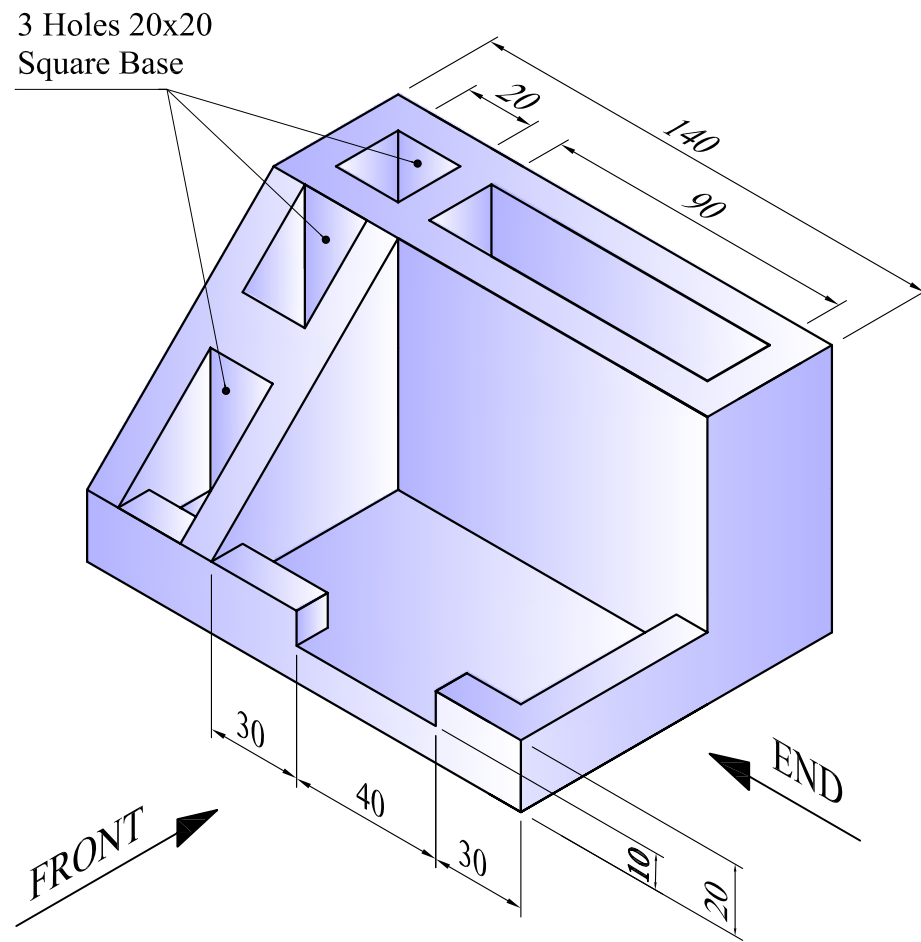

3 Holes 20x20
Square Base

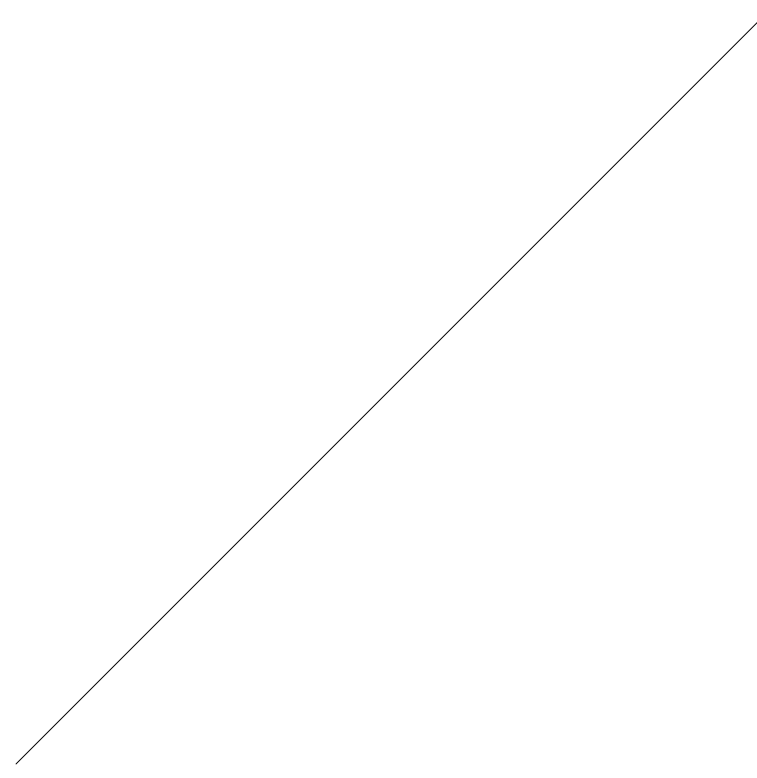

Plan

----- Scale :
Projection Symbol

Question 2. The logo shown in figure (i) is based on the construction of a regular pentagon. The mid-points of each side of the polygon are the centres of arcs R40 and R25.

Using the given line as the base:

- construct geometrically the pentagon.
- draw the necessary arcs and complete the logo.

16 marks

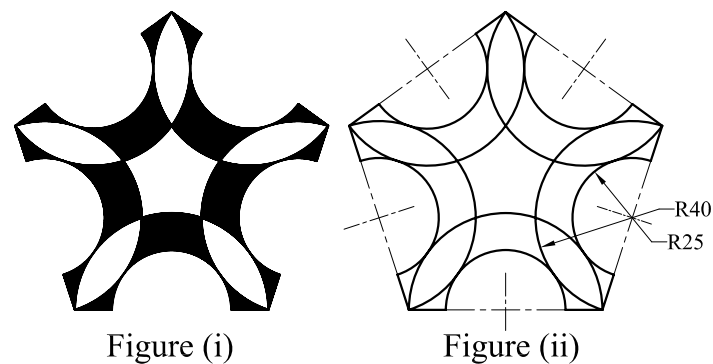

Question 3. The figure shows a wooden pizza peel which is used to handle the pizza before and after being cooked. Using the given start lines, draw the profile of the peel, showing clearly the constructions used to locate centres and points of tangencies.

Note: Centres of 15mm arcs a, b, c and d are given.

14 marks

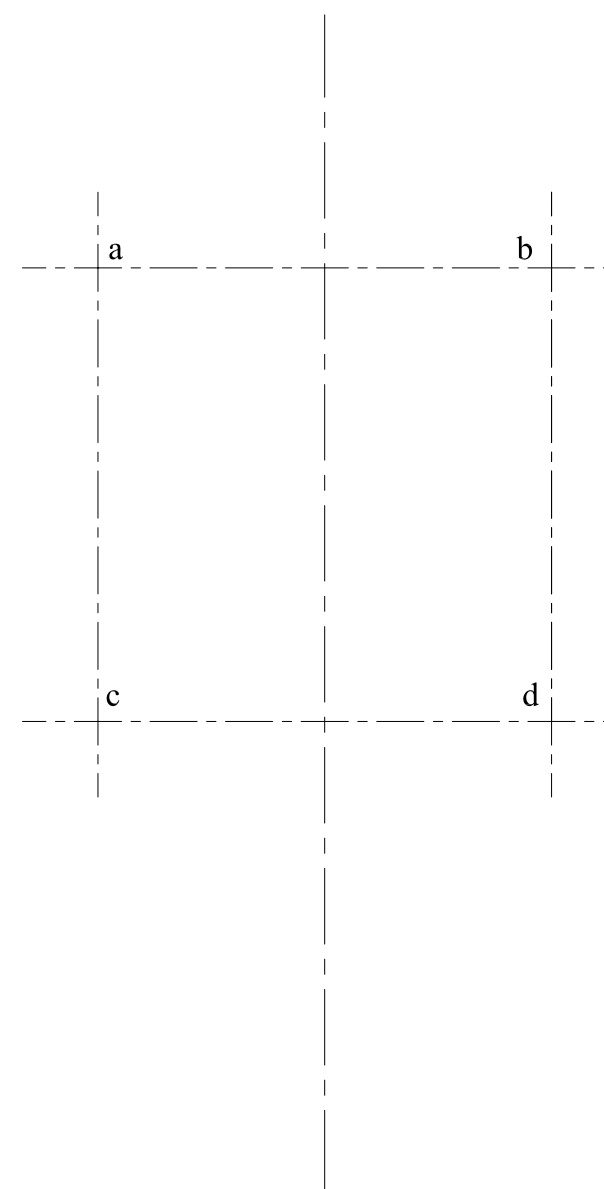
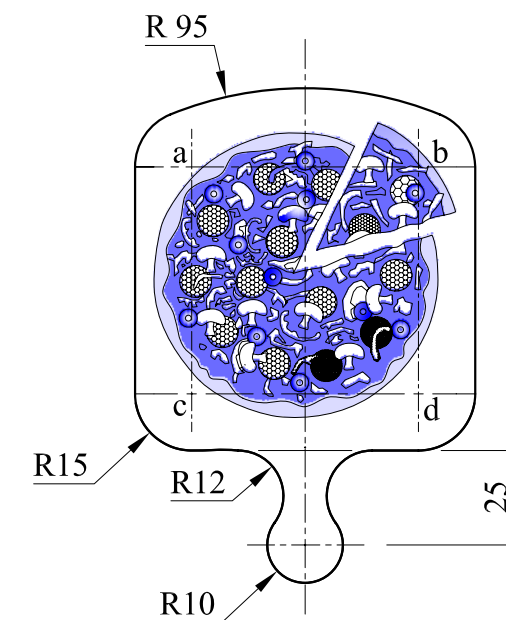

Question 4. Using the radial line method, enlarge the Jet plane profile given below such that side **oa** increases to **ob**.

Note: Use 'o' as the pole.

12 marks

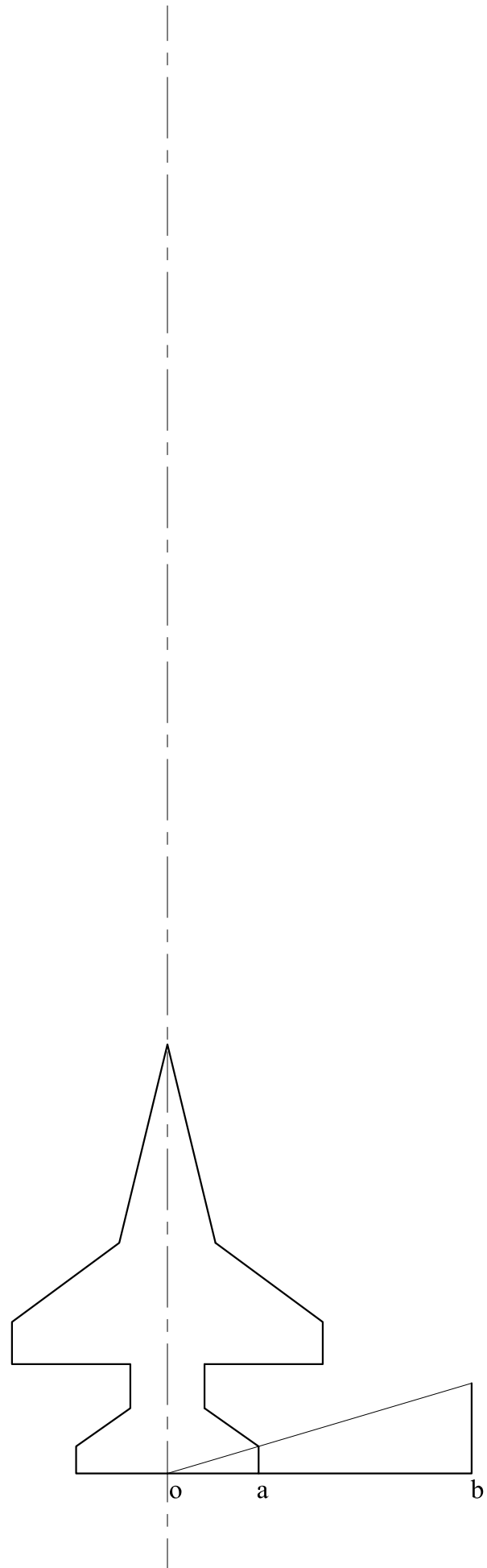

Question 5. An isometric view and a full size orthographic projection of a bracket are given. In the space provided below and on the given start lines, draw a cabinet oblique view of the object.

14 marks

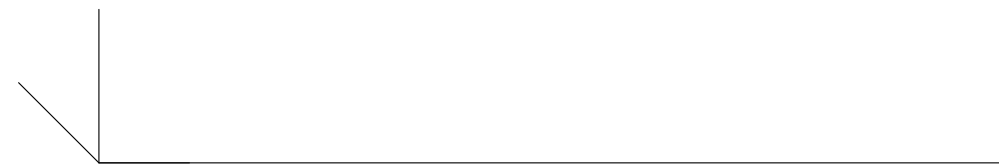
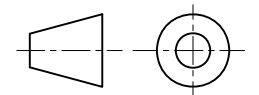
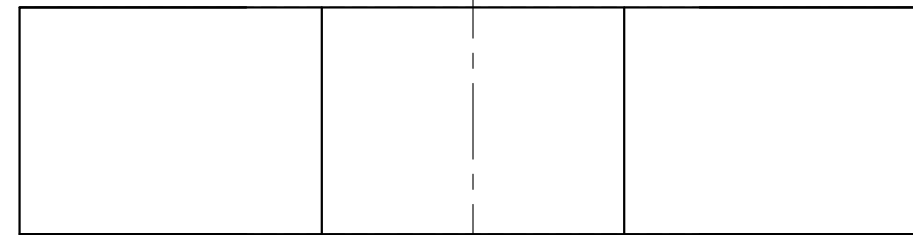
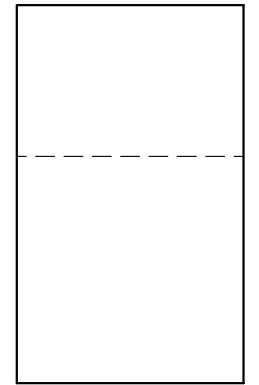
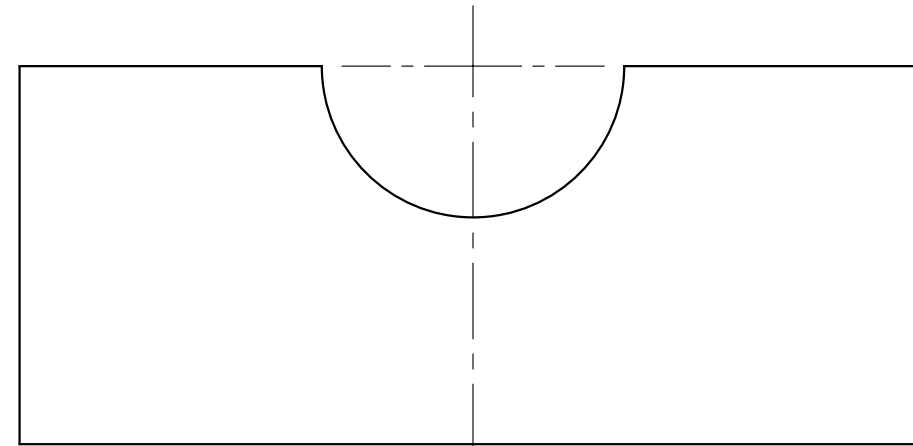
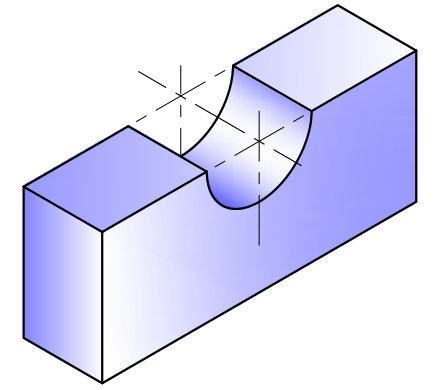

Question 6. A thin sheet metal model of a lantern is shown below. The front elevation and the plan of the cut square pyramid (which forms part of the lantern) are also given. Using the given space, draw the surface development of the pyramid.

14 marks

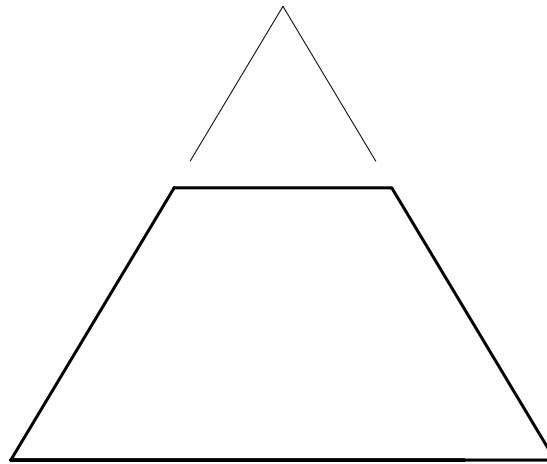
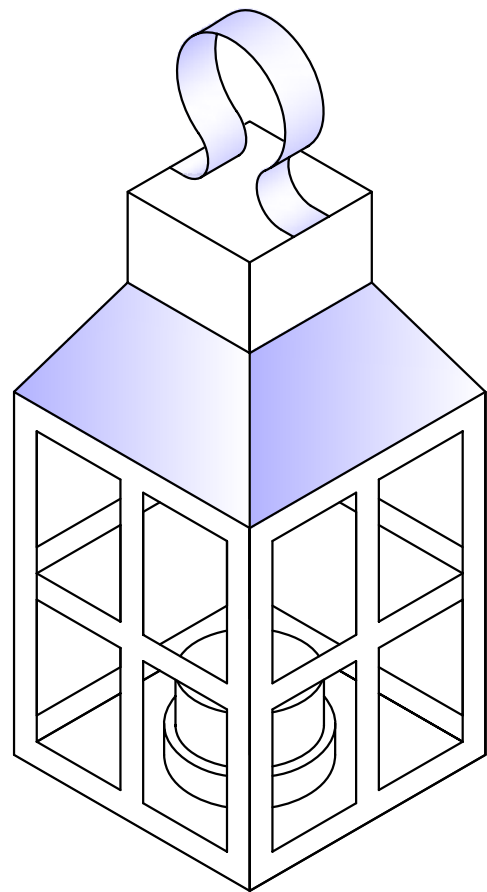

FRONT ELEVATION

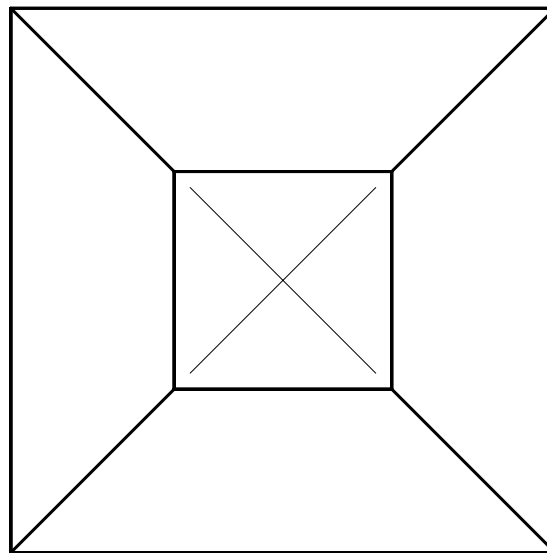

PLAN

SURFACE DEVELOPMENT OF PYRAMID

